

Little England Design A/S

Bentley 1.700 m.m. dobbel ende frittstående badekar.

Da våre støpejern badekar er produsert i en sand form vil det kunne være små avvik fra oppgitte mål.

Badekaret i 1.700 m.m. lengde er et standard produkt og er vanligvis lagervare i England. Badekaret i 1.540 m.m. er ikke lenger i produksjon.

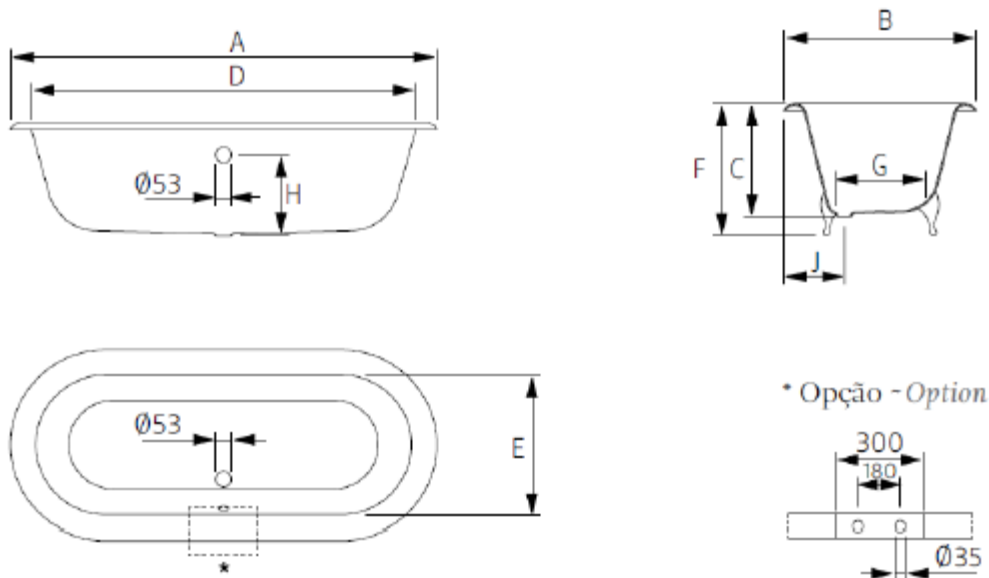

1540 1700	1540	780	473	1410	620	585	450	370	-	285	-	-	-	-	-	-	-
	1700	780	475	1560	620	585	450	372	-	275	-	-	-	-	-	-	-
	A	B	C	D	E	F	G	H	I	J	L	M	N	O	P	Q	R

1540		1700	
KG	LT	KG	LT
PESOWEIGHT 115	VOL. 170	PESOWEIGHT 130	VOL. 190

Ved bestilling må man oppgi om badekaret skal leveres med eller uten hull for montering av kar batteri på karets langside, samt om bena skal være hvite, krom, gull eller bare primet for egen dekorering (se prisliste)

Showroom & post : Båtbyggerlia 15, 1390 Vollen, Norway
Tlph. (0047) 22 55 4100. Mobile telephone (0047) 911 38 388
E-mail : littleng@online.no
Web: <http://www.little-england.no>

Bentley dobbel ende, frittstående støpejernsbadekar – montering av ben

INSTALLATION INSTRUCTIONS

Before you begin

Caution: Risk of personal injury or product damage. Cast Iron Baths are heavy, be prudent and get help when it comes to lift up the bathtub.

To ensure that this product is installed correctly please read the following instructions very carefully, before the installation of the feet.

We strongly advise that the installation shall be done by a qualified plumber.

Also be sure that your installation conforms to local codes.

Recommended Tools and Materials:

Adjustable wrench and Cardboard sheet

Feet Installation

1°: Turn the bathtub upside down in a cardboard sheet to avoid any damage on the enamelled surface, this operation needs to be done in a very careful manner.

2°: With Imperial feet all the feet are the same and can be positioned at any location on the bathtub.

With Tubular feet for size 1540 each of the feet provided is marked inside with the number 5, 6, 7 or 8.

With Tubular feet for size 1700 each of the feet provided is marked inside with the number 1, 2, 3 or 4.

Be sure you put the tubular feet in correct position considering the position of the waste hole as shown.

3°: Slot the angled bolt into the lugs, and afterwards connect the feet to the lugs by means of the nut and washer. Note that in first place the nut must be hand tighten.

4°: Now you can adjust the feet to its exact location on the bathtub, for that you can use the openings on both feet and bath. When you've reached the exact concordance between feet and bath, you must tighten the nut very firmly, for that you can use an adjustable wrench.

5°: Carefully place the bath in its normal position.

6°: All of the feet have levelling bolts on their lower extremity; you can use them to get a more exact assembly.

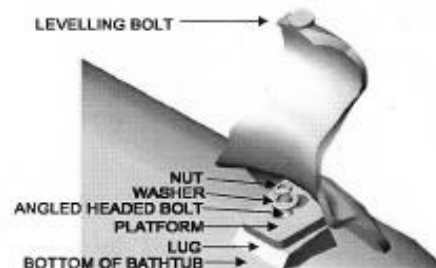
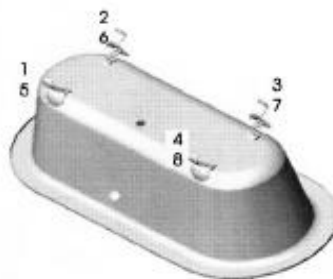

Your Cast Iron Bath:

The manufacturing process used in the enamel of a cast iron bath involves a thick coat of powder enamel being fused to the surface of a red hot bath. Evidence of this is reflected in individual characteristics inherent in every bath, such as dimples, a degree of surface ripple and small black specks.

These are quite normal and will not affect the life of your bath.

Recommendations:

Clean regularly with a non-abrasive cleaner.

If in doubt, contact your showroom or customer services prior to installation.

This bath should be dried after each use.

Avoid dripping taps.

Showroom & post : Båtbyggerlia 15, 1390 Vollen, Norway
Tlph. (0047) 22 55 4100. Mobile telephone (0047) 911 38 388

E-mail : littleng@online.no

Web: <http://www.little-england.no>